

North American Amphibian Monitoring Program

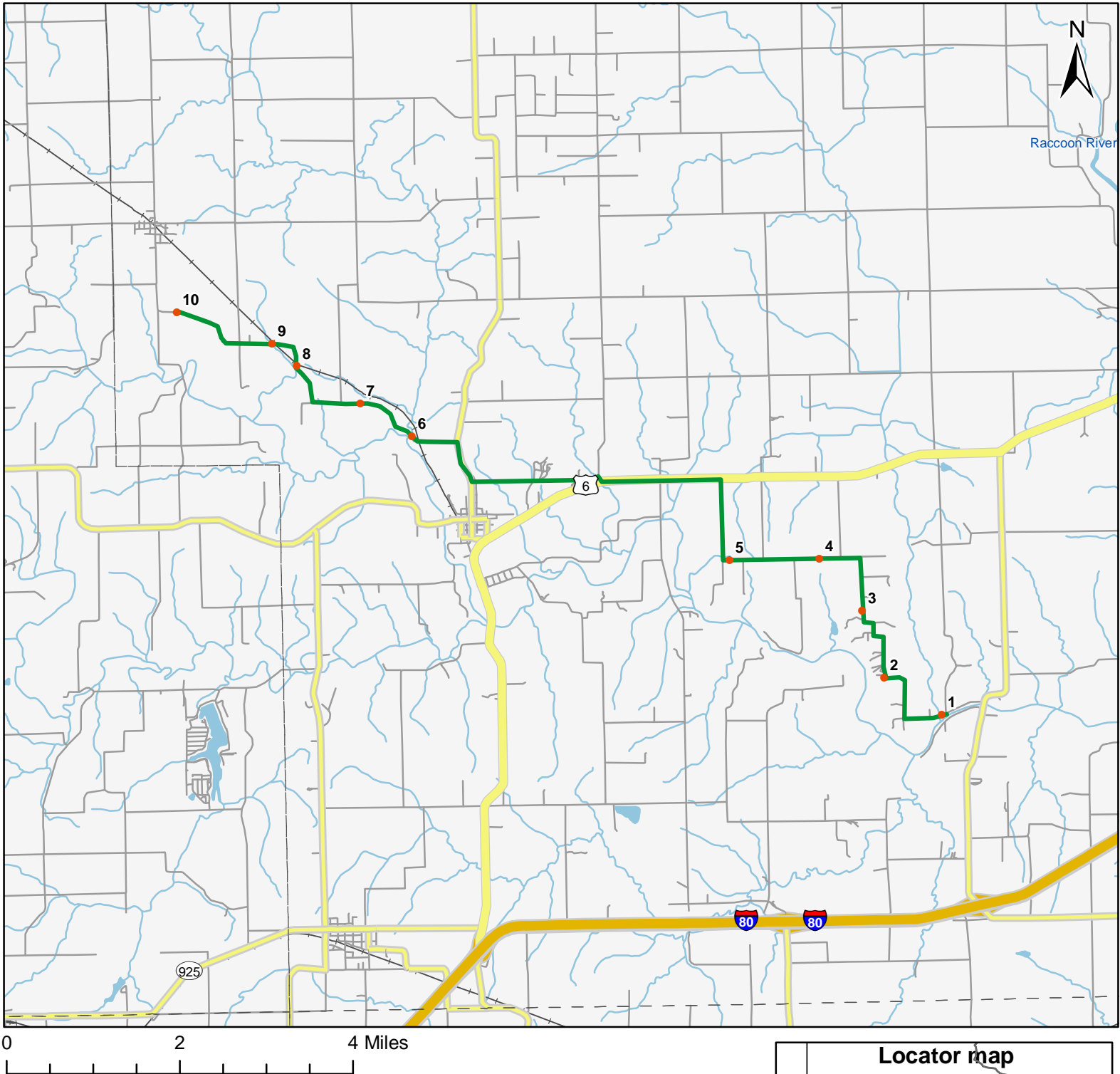

Route: 360316 Redfield, IA



Legend

- Stop Locations
- Route Path

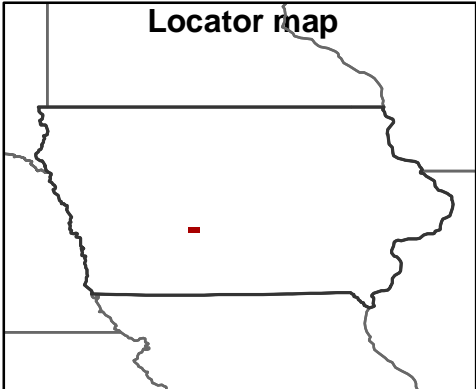

For more information, please visit the NAAMP website:
<http://www.pwrc.usgs.gov/naamp/>

Route: 360316 Redfield, IA

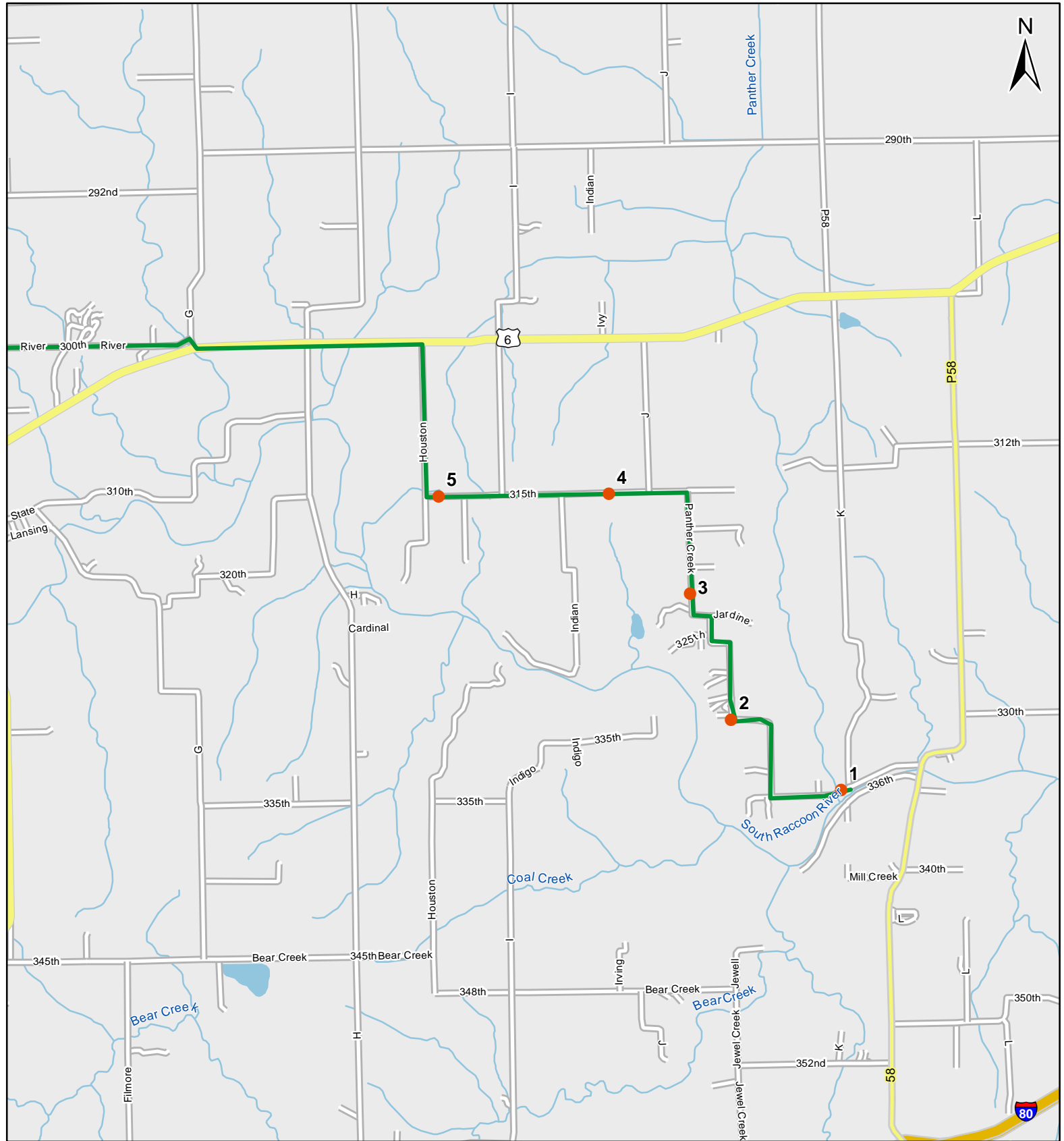

0 1 Miles

1:50,000

Legend

- Stop Locations
- Route Path

Route: 360316 Redfield, IA

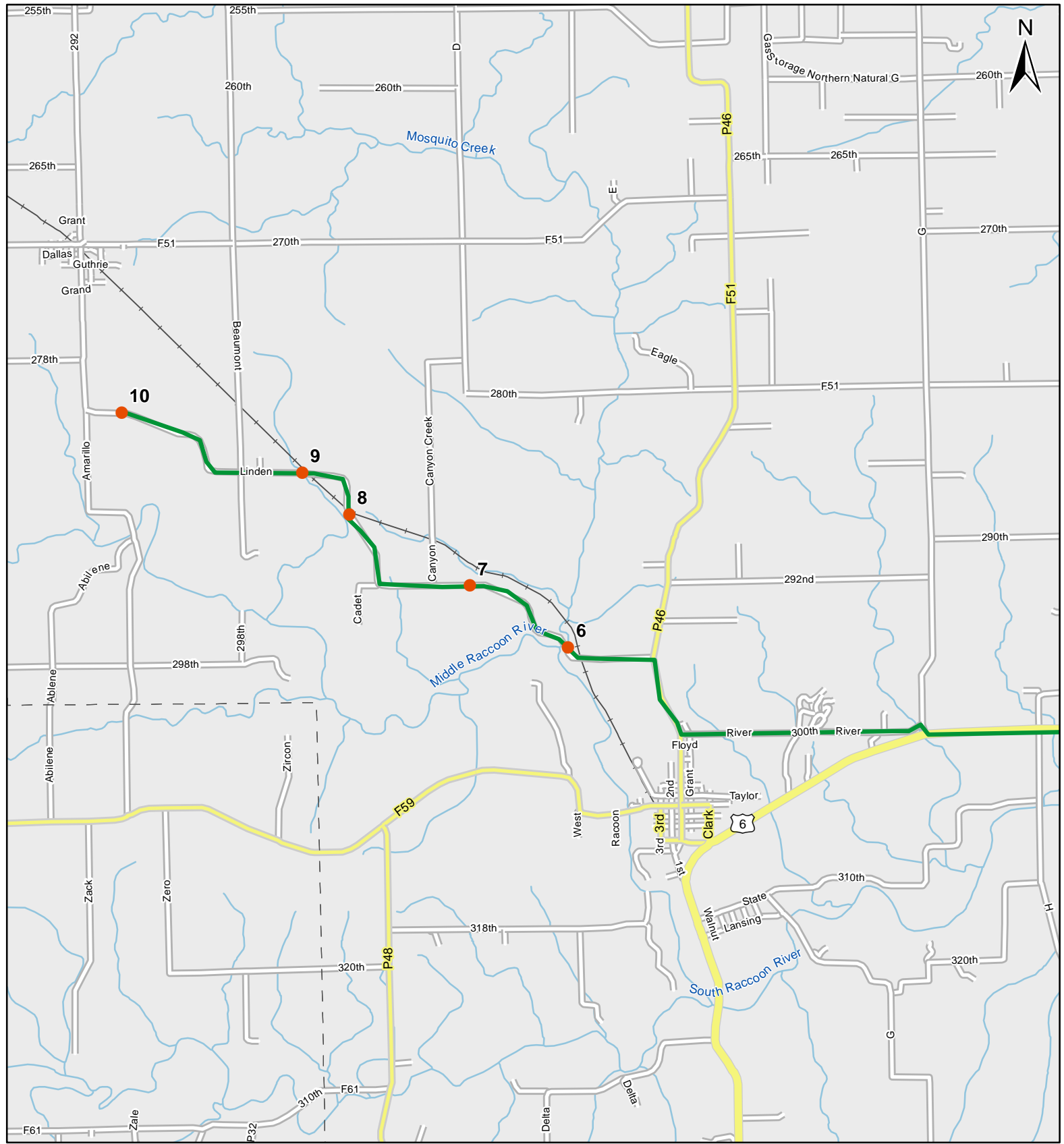

0 1 Miles

1:50,000

Legend

- Stop Locations
- Route Path



Frog and Toad Call Survey Route Description

Route ID **360316**

Established:

Site Number	Name	County	Latitude	Longitude	Directions
1	0.1	Dallas	41.5541	-94.0855026	Start at corner of K ave and Panther Creek Rd. There is a bridge about .1 miles west of corner. Start first survey there.
2	1.3	Dallas	41.5609016	-94.098999	Follow route for 1.2 miles. There is a good sized farm pand to the left of curve in road about 50 meters off road.
3	2.2	Dallas	41.5727997	-94.1037979	Continue on route for .9 miles to Glissman conservation area. Park in lot and do survey there.
4	3.4	Dallas	41.5824013	-94.1137009	Follow route for 1.2 miles until you are on 315th st. There is a large pond to the left (south) of road about 100 meters away.
5	4.4	Dallas	41.5824013	-94.1350021	Continue on 315th st west for 1.0 miles. Private little pond to the right (north) of road.
6	9.7	Dallas	41.6057014	-94.2097015	Follow route onto old hwy 6 into Redfield. Travel to T intersection. Turn right onto P46, then first left onto Linden Rd. The total trip is 5.3 miles to bridge over creek/river.
7	10.2	Dallas	41.6116982	-94.2219009	Continue on Linden rd for .7 miles. Farm pond to left (south) of road about 50 meters away.
8	11.2	Dallas	41.6185989	-94.2368011	Follow Linden for 1.0 miles. Little woodland stream to left of road.
9	11.7	Dallas	41.6226006	-94.2425003	Linden for another .5 miles. UNDER the road is another little creek.
10	13	Dallas	41.6286011	-94.2649994	Continue on Linden for 1.3 miles. Small hidden pond in trees to left (south) of road.